

PROPOSED SITE SECTION A-A
SCALE 1:200

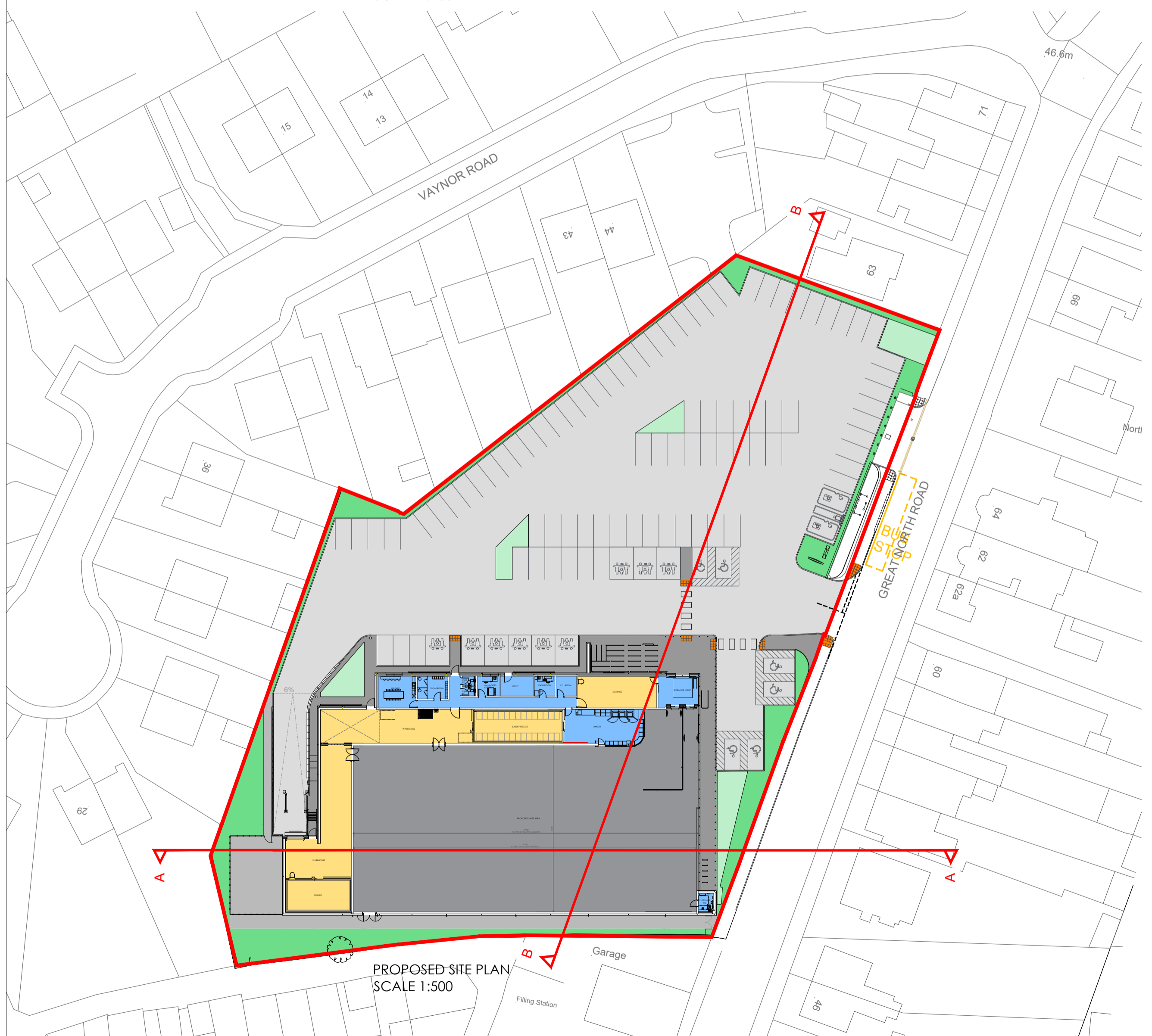

PROPOSED SITE SECTION B-B
SCALE 1:200



PROPOSED SITE PLAN
SCALE 1:500

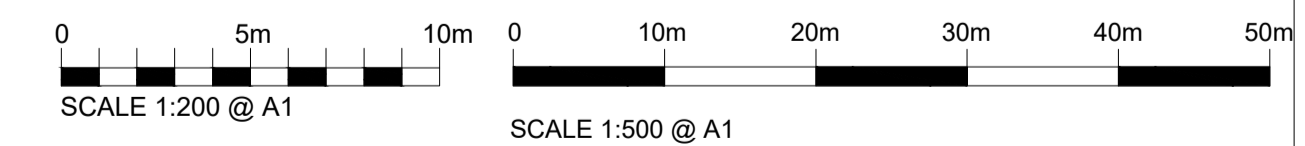

KEY:
— EXISTING LEVEL
— PROPOSED LEVEL

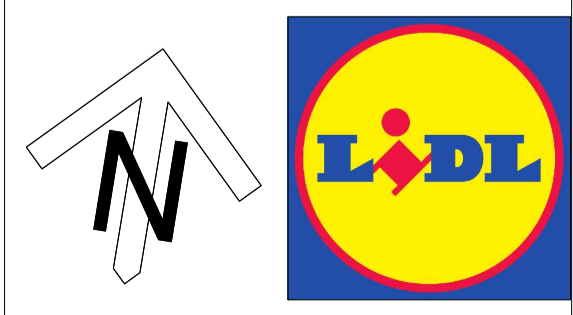

Client
LIDL GREAT BRITAIN LTD. Waterton
Industrial Estate, Bridgend, CF31 3PH
 Project
MILFORD HAVEN
 Drawing
PROPOSED SITE SECTION
 Project No:
19226
 Drawing No:
AD_123

Purpose of Issue
PLANNING
 Scale @ A1
AS SHOWN
 Drawn
SEN
 Checked
DGH
 Revision
-
 Date
JAN 2021

One Design Architects Ltd, Unit 1 Merchants Quay, Phase II, Ashley Lane, Shipley, West Yorkshire, BD17 7DB
 Tel: 01274 591188
 www.onedesignarchitects.com mail@onedesignarchitects.com
 Registered in England & Wales No: 8355643
Architectural

Notes

Revisions

Rev	Description	Date	Rev by	Chk by

DIMENSIONS TO BE CONFIRMED ON SITE PRIOR TO START OF WORKS AND ODA TO BE INFORMED OF DISCREPANCIES IMMEDIATELY. NO DIMENSIONS TO BE SCALED FROM THIS DRAWING.
 ALL MATERIALS AND WORKS ARE TO BE CARRIED OUT IN ACCORDANCE WITH THE LATEST REVISION OF THE APPROPRIATE BRITISH STANDARDS OR EURO CODE, PLANNING APPROVAL, CURRENT BUILDING REGULATIONS AND CODES OF PRACTICE.
 PARTY WALL ACT - NOTICES UNDER THE PARTY WALL ACT ARE TO BE SERVED BY THE PROPERTY OWNER OR APPOINTED THIRD PARTY BY PROPERTY OWNER. HEALTH AND SAFETY - CDM 2015 REGULATIONS APPLY TO ALL CONSTRUCTION WORKS TO BE CARRIED OUT AND APPLY TO DESIGNERS, CONTRACTORS AND THE CLIENT, AS SUCH ALL PARTIES HAVE DUTIES UNDER THESE REGULATIONS.